

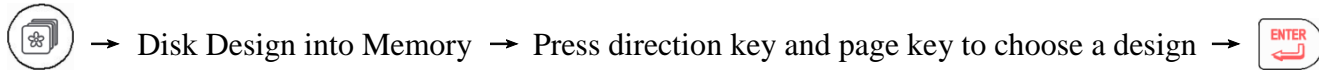

# BUTTERFLY MULTI-HEAD EMBROIDERY MACHINE CONTROL SYSTEM FAST MANUAL

## A. Input Designs



## B. Choose a Design

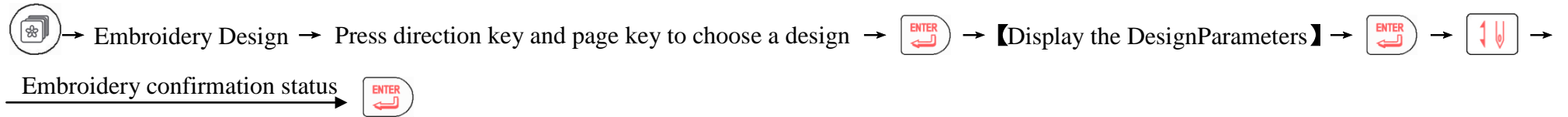

## C. Set Color Changing Sequence



## D. Manual Color-Changing

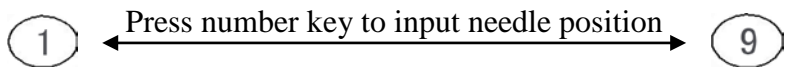

## E. Idling

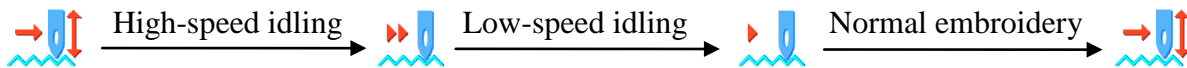

## F. Manual modification method

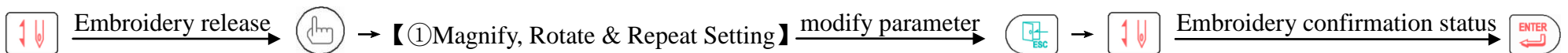

## G. Return to start point

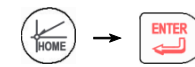

## H. Return to stop point



## I. Manual Trimming

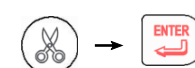



# BUTTERFLY MULTI-HEAD EMBROIDERY MACHINE CONTROL SYSTEM FAST MANUAL

## J. Set cyclic embroidery



## K. Setting another start



## L. Embroidery preparation

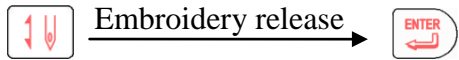

## M. Positioning idling



## N. Design border operation



## O. Manual frame moving

Direction Key: 、、、; Speed Shift of Manual Frame-moving:

## P. Let Needle Down



## Q. Speed up、Speed down

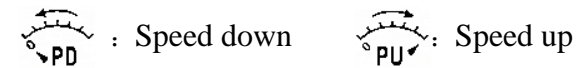

## R. Turn the Main Shaft to 100° Manually

